

Model: DU H Sluice Sink/Slop Hopper 1000mm

Description: A wall mounted stainless steel sink unit with continuous flushing rim and conical bowl for the disposal of liquid and solid waste. The unit has a raised anti-drip rim and 50mm sides turned down all round.

Available with TOP inlet, for exposed cistern, or REAR inlet, for concealed cistern.

Available with drainboard to the left or to the right.

This unit is HTM Compliant.

Dimensions: 1000mm x 600mm x 365mm (LxWxH)

Material: 1.5mm 304 Grade Stainless Steel

What's included?

- 1000 x 600mm 'DU' Sluice Sink.
- 110mm polypropylene waste trap (choice of 'P' or 'S' trap).
- Sink waste fitting.

Optional Extras:

- Front Legs
- Full Panelled Press Unit With Hinged Or Sliding Doors.
- Concealed Plastic Cistern (for rear inlet version)
- Stainless Steel Cistern (for top inlet version)
- Plastic Cistern (for top inlet version)



Top Inlet, Right Hand Drainer Version

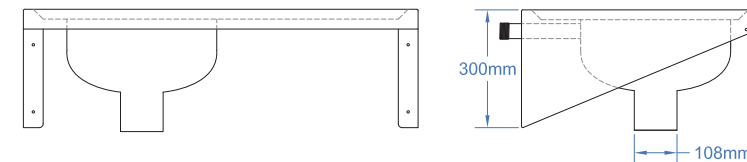
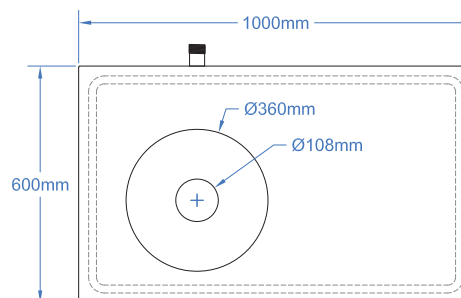
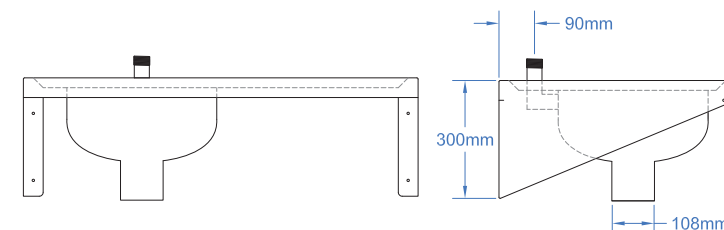
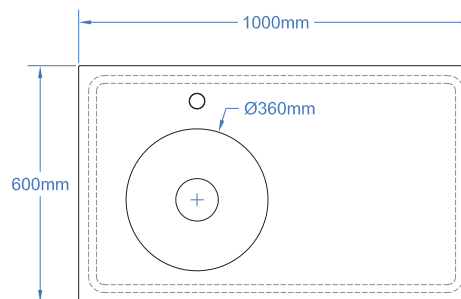

Rear Inlet Version